

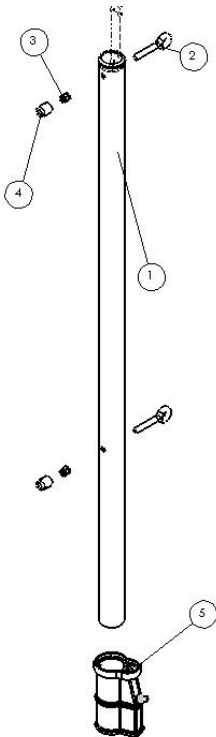

SWIM N' SPIKE VOLLEYBALL

ASSEMBLY AND INSTALLATION INSTRUCTIONS



<u>Item</u>	<u>Qty.</u>	<u>Part No.</u>	<u>Description</u>
1	2	20-109	Volleyball Post Ass'y
2	4	5-332-MG	3/8" S/S Eyebolt
3	4	800-2000	3/8" Lock Nut S/S
4	4	05-608	3/8" Black Nut Cap
5	2	AS-100P	ANCHOR PLASTIC 1.9" X 4" OR 6"
6	1	VBK-105	Net*, Needle & Ball

*20' (6 meter) net with 3' (915 mm) ties on each side

INSTALLATION INSTRUCTIONS:

1. Volleyball posts are to be anchored in the deck using 6-inch (153mm) deep Universal Anchor sockets. Install anchors in the pool deck at a location where the game will be played in shallow water depths. Bond anchors as required.
2. Attach the eyebolts to the volleyball posts as shown in the figure above.
3. Place the volleyball posts into the anchors, tighten wedges accordingly. Attach the volleyball net to the eyebolts of the volleyball posts. Ensure any loose rope from the net is properly secured so as to not provide a hazard.
4. Inflate the volleyball to the proper pressure with the needle provided.
5. Ensure caps are placed in the anchors whenever the volleyball posts have been removed.

SAFETY INSTRUCTIONS

- This equipment is intended for use in shallow water depths.
- During play, do not wear jewelry (rings, watches, necklaces etc.) Objects may entangle in net.
- When removing volleyball posts from anchors place cap in anchor for coverage.

SRS AUSTRALIA
12 Enterprise St
Richlands QLD 4077
Australia
Phone 07 3812 2283 • Fax 07 3812 1187
www.srsmith.com/au

S.R. SMITH, LLC
CORPORATE HEADQUARTERS
P.O. Box 400 • 1017 S.W. Berg Parkway
Canby, Oregon 97013
USA
Phone (503) 266 2231 • Fax (503) 266 4334
www.srsmith.com